

PNEUMATIC SCALING HAMMER - 3 PISTONS TYPE

I.CO. CODE 797-0 New Type

OPERATION:

Scabblers are rugged dependable tools designed to give you years, of satisfactory service. Follow the instructions mentioned here to enhance life and performance of your scabblers.

DAILY BEFORE OPERATING:

Disconnect and pour in 1 to 2 ounces of recommended oil into the tool and reconnect hose after blowing out any accumulated dirt in the hose line before connection.

LUBRICATION REQUIREMENTS:

Always install a line lubricator on the air line as close to the tool as possible. A Filter Regulator Lubricator unit (FRL) is strongly recommended. Keep the lubricator bowl topped up with recommended grade of oil and check that the oil is reaching the tool. Running the tool without lubrication is likely to cause damage to the components causing premature replacement.

RECOMMENDED LUBRICANTS:

	ABOVE 27°C - 80°F	5°C-27°C 80°F	40°F-	BELOW 5°C 40°F
SHELL	Toona R. 72	Toona R. 41		Toona R.27
MOBIL	Almo 529	Almo 527		Almo 525
ESSO	-----	Arox.EP.65		Arox EP.45
CALTEX	Rando Oil 100	Rando Oil 100		Rando Oil 46
CP	-----	-----		Airolene Tool Oil
TEXACO	Regal oil F (R&O)	Regal Oil PE (P&E)		Regal Oil PE (R&O)
DALTRON	Silkolene 881	Silkolene 548/T		Silkolene 733
BURMAH CASTROL	Castrol RD Oil 3	Castrol Rd Oil Light		Megna SPX
DUCKHAM	Garnet 7	Garnet 6		Zero Fio 5
STERNOL	Merlin 87	Merlin 71		Merlin 54
PETROFINA	Purifoc 53	Purifoc 46		Purifoc 32
CHEVRON	Vistac Oil 18X	Vistac Oil 19X		Vistac Oil 9X
IND OIL	Servo Spyn - 22	-----		-----

SAFETY INSTRUCTIONS:

Always wear suitable protection such as 'eye goggles' ear muffs' safety shoes etc. to safeguard against possibility of flying particles.

Never operate the tool over the rated 7 bar air pressure. Do not exert excessive pressure against the work surface. Keep hoses in good condition. Check hoses for signs of wear and ensure that fittings are secure. Accidental disconnection of hose while tool is in use can make the hose whip and can be a safety hazard. .

AIR SUPPLY:

The Scabblers work best at 5 to 7 bar air pressure. The air should be clean, dry and lubricated. Install a FRL unit as close to the scabblers as operation will permit.

MAINTENANCE:

To dis - assemble 3SC STD Scabblers, disconnect air supply and unscrew Cap for Cylinder (22). Slide out Spring (21) and Spring Cap (20). Unscrew Handle (4) from Cylinder Housing (14). Unscrew Control Body (5) from Handle (4), remove Plug (13) and slide out throttle Parts. Punch out Lever Pin (7) and remove Lever (6). Unscrew Slide handle (16) and Plug (17) from Cylinder Housing (14). Examine all components for wear after washing in a suitable solvent. Replace any worn or damaged components. Coat Parts with light oil and re - assemble carefully in reverse sequence.

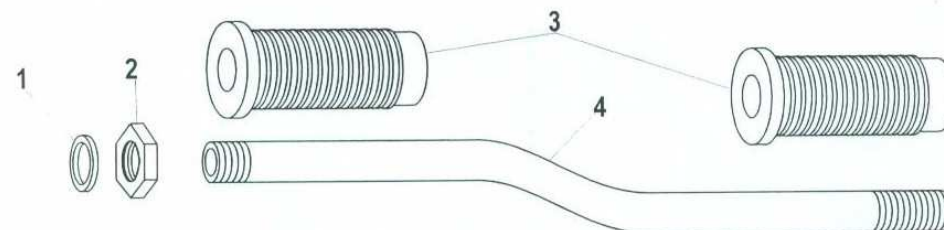

Illus. No.	Part. No.	Part Description	Qty / Tool
1	795 016	Washer Handle	2
2	795 015	Lock Nut Handle	1
3	795 014	Rubber Grip Handle	3
4	795 013	Handle	1
5	795 006	Control Body	1
6	795 010	Throttle Lever	1
7	795 011	Lever Pin	1
8	795 012	Adaptor	1
9	795 005	'O' Ring T Valve	1
10	795 004	Throttle Valve	1
11	795 003	Spring Throttle Valve	1
12	795 002	'O' Ring Plug Throttle Valve	1
13	795 001	Plug Throttle Valve	1
14	795 026	Cylinder Housing Standard	1
15	795 025	Wiper Seal	3
16	795 019	Side Handle	1
17	795 017	Plug Side Handle	1
18	795 024	Cylinder	3
19	795 035	T. C. Piston	3
20	795 022	Cap	3
21	795 021	Spring	3
22	795 020	Cap for Cylinder	3

